

Technical Information Package

Admiral Theatre Foundation

515 Pacific Ave
Bremerton, WA 98337
Office: 360-373-6810
Fax: 360-405-0673

Gail Walls, Production Stage Manager Ext. 315
Cell: (360) 981-0314 Gail@AdmiralTheatre.org

Mark Thomason, Technical Director Ext. 314
Cell: (360) 981-5883 Mark@AdmiralTheatre.org

Current as of January 1, 2010 for the 2009-2010 Season. Conforms to USITT standards layout.

Table of Contents:

Page 1)	Cover page, Table of Contents
Page 2)	Contact Information Area Hotels
Page 3)	Taxi Services, Restaurants, Grocers Handicapped Access Emergency Numbers & Locations
Page 4)	Parking Laundry Travel Directions, Location & Time Zone
Pages 5-6)	Management Information
Pages 6-7)	Venue Policies
Page 8)	Load-In
Pages 9-10)	Carpentry/Stage
Pages 11-12)	Lighting
Page 13)	Projection
Pages 14-15)	Audio Systems
Page 16)	Orchestra Pit Musician Backline
Pages 16-17)	Properties
Page 18)	Wardrobe Dressing Rooms
Page 19)	Attachments

General Information

Street and Mailing Address:

Admiral Theatre Foundation
515 Pacific Ave.
Bremerton, WA 98337
Fax: (360) 405-0673
Office: (360) 373-6810

Brian Johnson, General Manager
Ext. 302
Brian@Admiraltheatre.org

TECHNICAL CONTACTS:

Gail Walls, Production Stage Manager
Ext. 315
Cell: (360) 981-0314
Gail@AdmiralTheatre.org

Mark Thomason, Technical Director
Ext. 314
Cell: (360) 981-5883
Mark@AdmiralTheatre.org

PROGRAM / FRONT OF HOUSE:

Richard Padro, Events & House Manager
Ext. 304
Cell: (360) 981-3668
Richard@AdmiralTheatre.org

Robert Phillips, Events Asst. Manager
Ext. 319
Cell (360) 471-4538
Robert@AdmiralTheatre.org

BOX OFFICE:

(360) 373-6743
BoxOffice@AdmiralTheatre.org
(Please direct comp ticket questions to PSM Gail Walls)

MARKETING & PUBLICITY:

Tami Browning, Marketing Director
Ext. 313
Tami@AdmiralTheatre.org

HOTELS: When staying in town, we recommend:

Hampton Inn & Suites
150 Washington Ave.
Bremerton, WA 98309
Tel: (360) 405-0200
www.BremertonSuites.HamptonInn.com

Hampton is .3 mi. (.5km) south of the theatre.
(5 minute walk; 1 minute drive)
Room service is available on special request from Anthony's Restaurant next door.
Parking Garage: Bus parking requires special arrangement in advance.

Oyster Bay Inn
4412 Kitsap Way
Bremerton, WA 98312
Tel: (360) 377-5510
www.OysterBayInn.com

Oyster Bay Inn is 2.5 mi. (4km) west of theatre.
(6-8 minute drive)
Room service & restaurant in building
Limited Bus parking.

Super 8 Bremerton
5068 Kitsap Way
St Hwy 3 Exit Kitsap Way
Bremerton, WA 98312 US
(360) 377-8881

Super 8 is 3 mi. (4.8km) west of theatre.
(8-10 minute drive)
Inexpensive rooms
Bus Parking available, Pets allowed.
Denny's Restaurant next door.

TRANSPORTATION

Limousine Service – The Admiral Theatre recommends Galaxy Limousine Inc. for professional transportation in the Kitsap region. Toll free: (866) 874-2565 www.Galaxy-Limos.com

Taxi Services – Troll's Taxi II (360) 478-8600 www.trollstaxi2.com

Kitsap Airporter Service – Provides 24-hour shuttle service between Bremerton area and the Sea-Tac International Airport (SEA). (360) 876-1737 www.kitsapairporter.com

RESTAURANTS:

We Recommend:

The Boat Shed (360) 377-2600, 101 Shore Drive, Bremerton (Seafood)

New Dehli Restaurant (360) 782-2867, 221 Washington Ave, Bremerton (Indian)

Caffe' Perfetto (360) 434-7129, 2811 Wheaton Way, Bremerton (Coffee Shop)

Cornerstone Coffee (360) 479-3334, 435 Pacific Avenue, Bremerton (Coffee Shop)

Numerous additional excellent restaurants are within a five-minute walk of the theatre in all directions; by car even more are less than ten minutes away to the West or North. For 24-hour restaurants, Denny's and Shari's are both about 8-10 minutes away by car. Please contact PSM Gail Walls with any special requests.

GROCERY:

Several major grocers are available within a short drive from the theatre.

We recommend Garguiles Red Apple (360) 377-3908, 2901 Perry Avenue Mall, Bremerton

HANDICAPPED ACCESS:

The main floor of the theatre is wheel chair accessible. As the building is a renovated 1942 film house, the upstairs seating is generally not wheel chair accessible.

ADA family-style restroom is available on the main floor lobby.

Backstage areas are generally not wheel chair accessible, though some accommodations can be made upon special request. Please contact PSM Gail Walls with any backstage ADA needs.

Assisted Listening System: A complete modern ALS system is available for all performances. Patrons can pick up ALS receivers and a variety of headset options in the Coat Room.

EMERGENCY NUMBERS & LOCATIONS:

Dial 911 for all life-threatening emergencies. For non-emergency calls, use contact information below.

Bremerton Fire Department: (360) 473-5380, 911 Park Avenue, Bremerton, WA 98337

City of Bremerton Police Department: (360) 473-5224, 1025 Burwell Street, Bremerton, WA 98337

Ambulance: Dial 911

Harrison Memorial Hospital: (360) 377-3911, 2520 Cherry Avenue, Bremerton, WA 98310

Emergency Room: see Harrison Memorial Hospital above.

Urgent Care Clinic: see Harrison Memorial Hospital above.

Doyle Chiropractic Clinic: (360) 377-0012, 603 Chester Ave, Bremerton, WA 98337

Dental Clinic: Pacific Avenue Dental (360) 373-3515, 820 Pacific Ave # 204, Bremerton, WA 98337

Ophthalmologist: Kitsap Eye Physicians (360) 377-3703 2655 Wheaton Way, Bremerton

Rejuv Massage & Spa: (360) 405-0293, 2109 E. 11th St, Bremerton

(Building Supplies) Lowe's of Bremerton (360) 405-6270 5600 State Hwy 303 NE Bremerton, WA 98311

PARKING

The current parking system is under review by the theatre and the city. As such, this information is subject to change; please contact PSM Gail Walls for the latest information.

Up to four parallel parking spaces along 5th street are available to productions using the theatre. For presented events, the tech crew will cone off spaces in advance. Four additional spaces are available one block west on Park Ave. Additional bus and truck parking is available about three blocks from the theatre. Truck loading may be done in the alley but the truck must be moved when loading is complete.

LAUNDRY / 1 HOUR DRY CLEANING:

One-hour dry cleaning service is available within a short drive from the theatre.

Dry Cleaners: Eldon's One Hour Cleaners: M-F 7 am-6 pm (360) 373-0700

Irons, ironing boards, clothing steamer and washer/dryer are available backstage.

LOCATION: The Admiral Theatre is located in the heart of downtown Bremerton, ***approximately 90 minutes from Seattle-Tacoma Int'l Airport.*** Auto and Passenger Ferry service to downtown Seattle runs every 1-2 hours through the day with less service during evenings and weekends.

It is a 60-minute ferry ride; the ferry terminal is approximately .3 miles (.5km) from the theatre, a short walk or drive. ***Be warned that many GPS and online mapping programs do not take the ferry system into account properly and may give poor directions.*** Ferry times and fees can be found at www.wsdot.wa.gov/ferries/Schedule. The ferry terminals for this route are Bremerton and Seattle (Main).

DIRECTIONS: See attachment A for area maps and route.

Due to the unique location of Bremerton on the Kitsap Peninsula, nearly all travelers not familiar with the area will be coming from the South or East. In most cases, the best route is to navigate from Interstate 5, but depending on timing and schedules, it can be faster for those already in or North of Seattle to use the ferry system. Please contact PSM Gail Walls if you think the ferry system may be a faster route for you.

Bremerton is just a short drive from Seattle, the Sea-Tac Airport, and Tacoma via I-5 to Hwy 16 West, to Hwy 3 North. From I-5 take exit 132 to merge onto WA-16. Continue 27.4 mi. (44km) and then keep right, as Hwy 16 becomes WA-3 W. After 3.2 mi. (5.2km) more, take the Kitsap Way/WA-310 Exit from Hwy 3, and turn right (East). Kitsap Way becomes Sixth Street as you enter the Central Business District. Keep right to continue straight on 6th and then turn right on Pacific Avenue. The Admiral Theatre is on the corner of Fifth and Pacific.

Alternatively, take the ferry from Downtown Seattle to Bremerton, stay in the left lane and turn left on Burwell. Turn right at the light on Pacific Avenue, and the Admiral Theatre will be just ahead on the left.

TIME ZONE: Pacific Standard Time (GMT-8) / Pacific Daylight Time (GMT-7)
PDT Begins on the 2nd Sunday in March – PST begins on the first Sunday in November.

Management

PRODUCTION OFFICES:

A small production office with a phone connection and a desk for the touring company's production team is available backstage next to Dressing Room #1. A computer and printer/scanner/copier are available in this room. Direct (Ethernet) high-speed internet connection is also available. No phones are available in the dressing rooms. Secured wireless internet access is available in the house and onstage, but generally reception backstage is nonexistent. A regular full-size photocopier, fax machine, and additional office resources are available in the main offices – please ask our staff to assist you if you have any need to access the main office.

GREEN ROOM:

One floor down from the stage is the Green Room, which accommodates approximately 20. Cable television, couches and a microwave are available here for use by touring cast and crew as well as local staff. Please be aware that this space is also the access to the rehearsal room / second stage area and will be used by venue staff at all times. Depending on the parking/transportation setup this is usually the main artist's entrance to the building once load-in has completed. The outside door to the Green Room is marked "THE SOURCE" as the Green Room doubles as the patron entrance for performances when the rehearsal room is set up as a second performance space.

DRESSING ROOMS: See Attachment H for Dressing Room Plot

Six dressing rooms are available on two levels. Stage level dressing rooms include Dressing Rooms #1 and #2 with private bathroom (DR1 with a shower), which can accommodate 1-4 people, and Dressing Room #3, which can accommodate 6-8 with a bathroom across the hall. One floor up from stage level is Dressing Rm. #4 (ensemble) for 16 or more and #5 and #6 can accommodate 4-5 each. Bathrooms are available at this level, across the hall. Two full-size rolling wardrobe racks are available; Dressing rooms 4, 5, and 6 all have small built-in wardrobe racks; other small wardrobe racks are also available. No shower facilities are available except in dressing room #1. A wardrobe room backstage right at stage level can also be curtained off and set up to function as a seventh dressing room, accommodating an additional 8-10.

QUICK CHANGE: Two quick-change booths with curtained entrances are available backstage at SR, accessible from the crossover hallway or the DSR wing

STAGE MANAGERS CONSOLE:

Located Stage Right, DS. Video monitor can switch manually between IR and Color monitor. Backstage paging microphone, power outlets, house and work-light controls, and production intercom are all located here; a large (prompt-book-sized) podium is available for use.

Backstage Page – Monitor / Production Intercom. Paging and program sound are available to all dressing rooms and backstage areas, except for the loading dock and rehearsal room. When necessary, with advance notice paging and program sound as well as video monitoring can be provided in the rehearsal room.

REHEARSAL ROOM:

The Rehearsal Room downstairs is approximately the same size as the stage at 45' (13.72m) wide by 28' (8.54m) deep. It does have one support pillar in the middle of the room, slightly off-center. It is normally set up with numerous chairs and tables and serves as the cast and crew catering area for many performances, as well as doubling as a secondary performance space with a 12' (3.7m) by 8' (2.8m) platform in one corner acting as the stage. As such, if it needs to be cleared for use as a rehearsal space, please contact PSM Gail Walls at least a week in advance of your show.

CREWS:

NON – UNION THEATRE: The Admiral Theatre is a non-union theatre and does not employ members of IATSE. All crews are trained professionals, not student or volunteer. Volunteers, Students, or Interns may supplement crews when possible, but will never be used to replace professional crewmembers unless previously arranged with touring company. Please contact TD Mark Thomason with any special requirements or questions.

HANDICAP STAGE ACCESS: Wheelchair-accessible areas are limited and much of the backstage areas involve numerous stairways. No regular method of reaching the stage exists without the use of at least some stairs. Handicap-accessible restrooms are available at stage level and at the level of the rehearsal room downstairs. Please contact PSM Gail Walls to make any special arrangements.

POLICIES:

HOUSE OPEN – 2 Hours prior to show

Please be aware that the Admiral Theatre house policies are atypical. For many of our shows, we provide our patrons purchasing prime seats on the main floor to order a complete 3-course meal before the performance. In order to provide time to serve the meal and clear dishes before the performance starts, for these shows ***the house will open to the public 2 hours prior to the scheduled start time.*** Typically evening shows begin at 8pm and so the house opens at 6pm.

For all shows without a meal option, we provide a full bar and, for most shows, a variety of appetizers for our patrons to order. Again, in order to have dishes cleared and minimize the interference with the performance, for all events without a meal option, the house will ***open to the public 1 hour prior*** to the scheduled start time. As our bar is inside the house rather than in the lobby, even for shows without any food service, the house will still open at 1-hour prior to the show. As many of our patrons arrive early to enjoy the food and bar available, ***all stage setup and sound check must be complete by the scheduled house open time.*** Please account for this in your scheduling.

NO-SMOKING

There is no smoking allowed anywhere in the theatre. This policy applies to artists, members of their band and crew, the staff of the theatre and the audience. Smoking is permitted outside the facility only, and in accordance with state law, should be a minimum of 25 feet (7.62m) away from all doors to any building. This is not only in compliance with the laws of the State of Washington, but is a necessary requirement as smoking in dressing rooms, restrooms and hallways will set off fire alarms in the entire building.

ALCOHOL POLICY

In order to conform to explicit WA state liquor license concerns, no outside alcohol is allowed in the building. A limited amount of alcohol can be provided backstage by our staff; for any additional needs please contact PSM Gail Walls or see the Stage Manager who can provide additional drinks from the house bar on request.

FOOD AND DRINKS ONSTAGE

Only water in a closeable plastic container is permitted on stage at any time. Other food and drinks are permitted in dressing rooms and other backstage areas. Once the house has opened please speak with the Stage Manager to arrange any food or drink coming from front of house.

RECORDING OF SHOWS

No Audio/Video recording of any kind will be made except by prior arrangement in writing a minimum of 48 hours in advance of the show. All arrangements for audio or video recording must be made through the Technical

Director. Absolutely NO FLASH PHOTOGRAPHY is allowed at any time. Non-flash photography is permitted at the discretion of the artist's representative.

INTERMISSION

Any events lasting more than 75 minutes in length must have at least one 15-minute intermission. Any exceptions to this policy must be arranged in writing in advance of the day of the show. Any changes in the length or timing of intermissions must be arranged with the Stage Manager and House Manager.

VENUE MANAGEMENT

In order to assure proper handling of emergency situations, the venue's Stage Manager or Technical Director is required to be in direct communication with touring management staff during the show. Normally this means one headset must be reserved for venue management, though usually this person will also fulfill one of the crew duties. While touring management may have ultimate control of decisions affecting the performance, the venue Stage Manager will have final say in safety concerns and emergency response.

STAGE TO HOUSE ACCESS

Access directly from the stage to the house is available by permanently installed stairs on either side of the stage; it is requested that the Stage Manager be informed before the performance if the artist wishes to use the steps during the show. Additionally, once the house has opened, it is important that no one use this route to access backstage before or after the show; there is a cross-under route from the SL corner of the house under the stage to the backstage areas. This policy is actually a matter of security and safety; we have found that our patrons will follow performers or crew up on the stage if they see anyone using this route to get backstage.

Also, under no circumstances will anyone be allowed to go around the grand drape on the outside edges, as this requires extremely unsafe maneuvering around installed sound, lighting, and rigging equipment, and reveals the entire fly rail area to the audience. Should access through a closed grand be required, it can be arranged to have a crewmember page the curtain at center stage.

STAGE ACCESS

It is requested that no performers or crew not dressed entirely in stage blacks walk out onto stage once the house has opened unless the grand curtain is closed. Should a performer need to access the stage, such as to place music or retrieve an instrument or prop, please contact the Stage Manager who will have a crew person place or retrieve the necessary items. Artists walking on stage are usually noticed by the patrons, which can cause problems for the house staff.

Security varies depending on the event. Performances with higher security requirements will have all entrances to the entire backstage area controlled by Security staff who will be checking for venue or performer backstage passes – please provide your crew industry-standard access passes or make arrangements in advance with the PSM for the Admiral Theatre to provide enough passes for your crew.

LOAD-IN

There is no stage-level loading at the theatre. Load-in is accomplished from the back alley between 5th and 6th street through a 10'x10' (3m x 3m) loading door into a staging area. The loading dock is not level with the alley, and varies (as the alley is sloped) from 12"-19" above immediate street level. A variety of options for loading include placing an 8'x8' (2.4m x 2.4m) platform in the alley which is level with the loading area. There is also a ramp around the corner for rolling cases, but this route requires passing through a 2'-10.5" (0.87m) wide by 7' (2.13m) high doorway. See drawing for more specifics.

All gear must then be transferred through a 10' (3m) wide by 8' (2.4m) high 1" (2.6cm) doorway onto the loading elevator (6000 lbs/2721kg weight limit) which is 12' (3.65m) wide by 8'-4" (2.5m) deep by 12' (3.65m) high. The elevator goes up to the backstage area where it can be ramped down a slight incline (10"/25cm drop) through an 11'-8" (3.5m) wide by 10' (3m) high doorway to the stage at USL. Load-in to the house can be accomplished via the main entrance on Pacific through a 3' (.9m) wide doorway, or up a short flight (4'/1.21m rise) of stairs through 5' (1.52m) W x 10' (3m) H doors. Please contact TD Mark Thomason with any questions or concerns about loading in your performance.

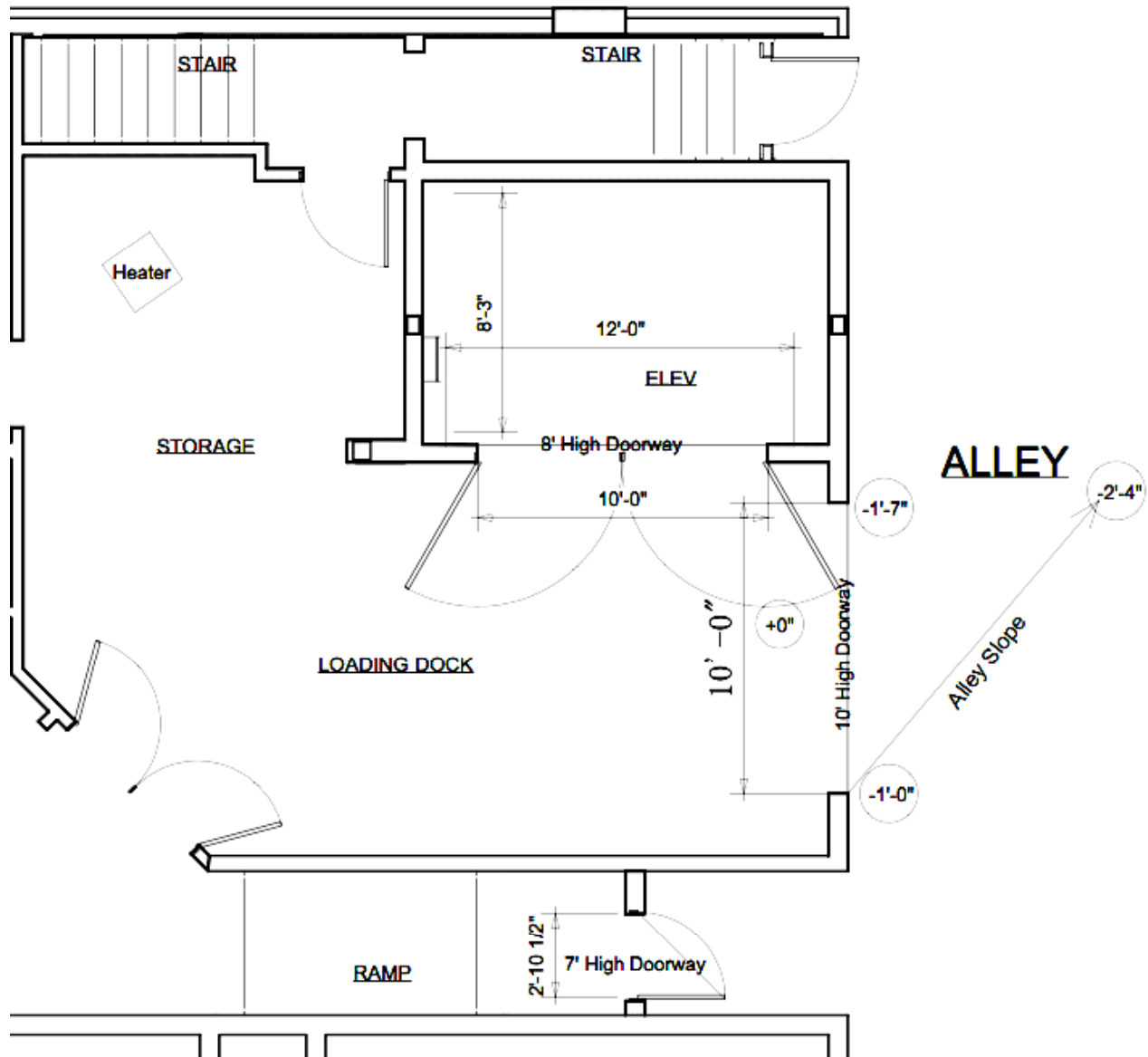

Carpentry Department – Stage Facilities

SEATING:

Standard setup is 822 seats; 502 traditional theatrical-style raked seats in the balcony, plus 320 seats at tables on the level main floor. 72 of these 320 seats are one level up onto a terraced area under the balcony. Orchestra pit is between the front row and the stage; when opened up 16 seats are removed. **For standard seating charts, see attachment E.** For many daytime children's shows, the tables are removed and more seats are put out on the main floor. For some concerts, all or most chairs and tables are removed from the main floor and tickets are general admission. Maximum patron capacity of the room in either situation is 999.

STAGE DIMENSIONS: *Please see attachment B for better clarity on stage dimensions.* There is no traditional proscenium arch and the performing area is trapezoidal, getting narrower than the house upstage. Stage is 40'-0" (12.2m) wide at upstage edge, 30'-0" (9.1m) deep from plaster line to upstage wall 27'-0" (8.2m) from plaster line to cyclorama 3'-0" (.91m) from cyc to upstage wall. 5'-3" (1.6m) from plaster line to downstage edge of apron.

Proscenium Opening: Maximum of 47'-6" (14.5m)W by 22'-0" (6.7m)H. Width varies as traveler-style main curtain and dead-hung teaser provide actual proscenium; there is no architectural proscenium wall. Midstage traveler maximum opening is 36'-9" (11.2m). Upstage traveler maximum opening is 33'-6" (10.2m).

Wing Space: Varies dramatically, as stage walls angle in as they come upstage. At proscenium, wings are 10' (4.6m) each side (assuming maximum opening of all curtains) while at mid-stage 8' (2.4m) wide each side, and at upstage edge are 5' (1.5m) wide. Upstage and midstage travelers are usually brought in a few feet to create slightly larger wings, limiting visible cyc area to about 30' (9.1m) wide.

Grid Height: There is no standard grid. Fly system head blocks are mounted directly to ceiling I-Beams. 41'-6" (12.65m) stage floor to ceiling I-Beam; maximum height of flown battens is 35-38' (10-12m).

Orchestra Pit: *Please see attachment L for Orchestra Layout*

When open, the orchestra pit extends from under stage to 6' (1.8m) beyond the apron edge at center. It normally accommodates 28-32 musicians. There is no elevator; the pit cover is created with custom Wenger platforms and typically requires 4 crew for about 2 hours to remove or reinstall. It does not usually require removal of seating though some adjustment is necessary.

40'-0" (12.2m) wide

14'-0" (4.3m) deep at center

11'-0" (3.4m) deep at SR/SL edge

-8'-5" (-2.57m) from stage elevation

The Pit Cover can also be raised up to stage level to provide a curving apron at the front of the stage, though this creates some sight-line issues with the front rows and balcony seating. There are no additional traps or openings in the stage.

There is available a platform system to create a conductor's podium and 3 additional levels of orchestra seating, stepping down from the conductor's position at center to the orchestra floor at the back and sides.

Stage Height: The stage is 4' (1.22m) above the main floor of the auditorium.

Stage Floor: The permanent stage floor is ¼" (6mm) tempered Masonite over fir on rubber spacers. It is painted a semi-gloss black. Drywall screws may be used on the floor. A 41' (12.5m) wide by 26' (7.9m) deep Harlequin Reversible dance floor is available when needed.

HOUSE DRAPERIES:

Main Curtain: Dark Emerald Green velour 100% fullness traveler at plaster line, manually operated from SR next to SM Console. Masked by 10' (3m) high Dark Emerald Green 100% fullness dead-hung Border.

Legs: (4) sets black velour 26' (7.9m) high x 10' (3m) wide. 50% fullness. Note that though flown, due to limited fly space, legs only fly out to a height of 9' (2.7m) above stage.

Borders: (4) black velour 10' (3m) high x 50' (15.2m) wide borders, 50% fullness. All flown.

Full-Stage: (2) black 45' (13.7m) wide x 26' (7.9m) high velour full-stage travelers, 50% fullness, dead-hung at 12'-0" (3.66m) upstage of plaster line and 22'-6" (6.9m) upstage of plaster line.

Scrim: (1) white sharks-tooth scrim, approx. 26' (7.9m) high x 50' (15.2m) wide. Note that due to fly height this must be double-tripped to fly in and out fully.

Cyclorama: Sky Blue seamed muslin cyclorama, 22' (6.7m) high x 45' (13.7m) wide.

Movie Screen: a standard film-style front-projection 20' (6m) high x 42' (12.8m) wide movie screen is permanently hung on line-set 6 at 7'-6" (2.3m) upstage of the plaster line. Maximum clearance when flown out is 20'-6" (6.25m).

RP Screen: a 10' (3m)W x 7' (2.2m)H grey rear projection screen is available and is normally flown on line-set 7.

LINE SET DATA:

See attachment D for Line Set Plot and Line Set Schedule. Grand Border and all Travelers are dead-hung; Movie Screen on line set 6 is not removable.

Working Height of Battens: All line sets have a low trim of 4' (1.2m). High trim on electrics is 28' (8.5m); on all other line sets high trim is 36' (11m).

Battens: Batten length varies from 40' (12.2m) to 50'-6" (15.4m); there are 18 operating line sets: of these 3 are electrics. All battens are 1 1/2" (38mm) Schedule 40 Pipe and are on 1' (30cm) centers, with various irregularities due to structural barriers.

Type: All systems are single-purchase counterweight. Line sets 1-8 are loaded from a loading bridge; line sets 9-18 are loaded from stage level and a 500lb-capacity winch with block and tackle is available to assist with heavier loads. 1 rope is also available for use as a bull line.

Arbor Capacity: Maximum load 1200 lbs per batten; 500 lbs point load per head block.

Available Weight: Several thousand pounds of steel weight are available at the deck and on the loading bridge.

Loading Gallery: SR, 34' (10.4m) above deck. Accessed from SR ladder or from catwalks over house.

Fly Rail: SR – Line sets 1-8 are along wall behind SM's console; Line sets 9-18 are alongside SR stage edge onstage from backstage access hallway.

Rigging Notes: FOH PA speaker array is hung from permanently installed chain motors operated from within the ceiling. No other hard points exist overhead; all rigging must utilize standard line set systems.

SUPPORT AREAS:

Crossover: A 12' (3.7m)W by 10' (3m)H opening in the upstage wall SL provides access to a crossover hall behind the stage.

Stage Access to backstage area is downstage right, or from the back of the stage upstage left, through the crossover hallway. Dressing Rooms are located in the areas SR of the stage; the green room is down the stairs accessible from this area as well. Access to FOH from here is down the stairs past the green room and through the cross-under to House Right.

Shop Areas and Storage: USL access to crossover hallway also provides ramped access to the storage areas and shop. The loading elevator access is here as well. Woodworking and electrical tools are available in the tool room, attached to the shop at the SR side. No welding or other metalwork tools are available. This area and the loading dock directly below provide the primary storage areas for both venue equipment and touring gear. No storage areas are available easily accessible from FOH.

LIGHTING SYSTEM:

Power Supply: Primary lighting power supply is provided to permanently installed dimmers. Company Switches are available SL and in the shop area across from the elevator; both services are 120/208 3-phase 200A services with only bare-lug connectors, no Cam-Lok.

Dimmers: 198 total independently-controllable dimmers
96 ET IPS Intelligent Raceway Series at FOH Catwalks. 2.4Kw max per two dimmers.
96 @ 2.4Kw SCR ETC Sensor Dimmers onstage. System is circuit-per-dimmer setup.
6@1.2Kw ETC SmartModule unit at Balcony Rail.

Control: ETC Express 48/96. Normally channels 81-192 are reserved for moving light control. Console is located on the main floor, center, in front of the terrace. DMX input can be run to the entire network (single universe) from either at the tech deck or from the Dimmer Room, which is below the DSL corner of the stage.

House Lights: Controlled by NSI Lumanet system from FOH Tech Deck next to lighting console, or from SR SM's Podium, or from Spotlight/Projection booth. Does not currently receive DMX.

Circuits: All Circuits use 20A Stage Pin Connectors

Over-Stage: Trim height on all over-stage electrics is approximately 24' typical.

1st Electric: (25) Circuits, 2.4K ETC Sensor Dimmers

2nd Electric: (25) Circuits, 2.4K ETC Sensor Dimmers

3rd Electric: (25) Circuits, 2.4K ETC Sensor Dimmers

4th Electric: (6) Circuits, 2.4K ETC Sensor Dimmers, all in use for cyc lights.

(12) Additional circuits on drop boxes, 2 or 4 circuits per box: 6 circuits at SL, 6 at SR.

Balcony Rail: (6) Circuits, 1.2Kw ETC Smart Module

Front Catwalks: (44) Circuits, 2.4Kw per pair ET Intelligent Raceway

Back Catwalk: (52) Circuits, 2.4Kw per pair ET Intelligent Raceway

Circuit Chart: See Attachment F

Circuit Plot: See Attachment G

House Plot: See Attachment J

House Patch: See Attachment K

Vectorworks (mcd) or CAD transfer(dxg/dwg) files available on request.

Lighting Positions:

Front of House: 4 catwalks at +34' above stage level

Front Center catwalk is 32' from plaster line, horizontally. 24' long, centered. Throw to PL +5'-0" is 42' at a 40 deg. angle.

Front Side catwalks are 28' from plaster line, horizontally. 8' long, begin approx. 24' off of center and end 31' off of center. Throw to PL +5'-0" is 40' at a 45 deg. angle

Back Catwalk is 48' horizontally from plaster line. Back catwalk travels full width of 66'. Throw to PL +5'-0" is 55' at a 32deg angle.

Balcony Rail is 5 – 10'-0" long battens mounted to the curved front of the balcony. +10'-0" above stage level.

Throw to center mark at PL +5'-0" to center balcony rail is 38' at a 7 deg. angle. Throw to center mark at PL +5'-0" to outside edges of balcony rail is 44' at a 7 deg. angle. Balcony Rail currently has 6 – 10amp circuits.

Lighting Instrument Inventory: All Instruments use 20A Stage Pin Connectors.

- (12) Altman 360Q 6X16 ERS w/Iris 575w 7.5" (190mm) Color Frame
- (22) Altman 360Q 6X16 ERS 575w 7.5" (190mm) Color Frame
- (6) Altman 360Q 6X12 ERS 575w 7.5" (190mm) Color Frame
- (4) Altman 360Q 6 X 9 ERS 575w 7.5" (190mm) Color Frame
- (2) Altman Shakespeare 10 Degree ERS 600w 12" (304mm) Color Frame
- (16) Altman Shakespeare 15-35 Degree Zoom ERS 600w 6.25" (159mm) Color Frame
- (22) Altman Shakespeare 40 Degree ERS 600w 6.25" (159mm) Color Frame
- (2) Selecon Pacific Zoom ERS 23 Deg. – 50 Deg. 600w 6.25" (159mm) Color Frame
- (24) ETC Source 4 ERS instrument bodies 575w
- (6) ETC Source 4 10 Degree lenses only 12" (304mm) Color Frame
- (4) ETC Source 4 19 Degree lenses only 6.25" (159mm) Color Frame
- (10) ETC Source 4 26 Degree lenses only 6.25" (159mm) Color Frame
- (10) ETC Source 4 36 Degree lenses only 6.25" (159mm) Color Frame
- (4) ETC Source 4 50 Degree lenses only 6.25" (159mm) Color Frame
- (6) ETC Source 4 PAR w/lenses (VNSP NSP MFL WFL) 575w 7.5" (190mm) CF
- (42) Altman PAR 64 WFL/MFL 1Kw 10" (254mm) Color Frame
- (8) Colortran Far Cyc 3-Cell 1kw per cell 15"x16" Color Frame
- (4) R-40 3 circuit strip lights on stands for ground row. 150w PAR lamps, RGB glass
- (2) High End Systems Cyberlights (FOH L&R)
- (4) High End Systems Technobeams (Over-stage at corners)
- (9) Wybron ColorRAM Color Scrollers (Toplight positions)

Followspots:

- (1) Altman Satellite Followspot
- (1) Phoebus Ultra Arc II Followspot

Followspot Positions:

Dual spotlight setup is available in the booth at the back of theatre just SR of center. Spotlights can also be set up at the front corners of the balcony, one on each side. When arrangements need to be made for additional spotlights, spot platforms can be installed at the back of the house in the far corners, but this requires removal of approximately 2 dozen balcony audience seats. (12 kills per side)

Hardware:

- 6 10" Tophats for PAR64's
- 6 7" Barn Doors for S4 PARS
- 4 Floor Bases
- 6 Freestanding booms on steel bases reaching 12' (3.7m) high are available for side lighting positions, as well as two permanent booms at center Left and Right reaching +8' (2.4m) to +16' (4.9m). Circuits are run from drop boxes.
- 2 Template holders for Selecon Pacifics
- 6 Template holders for ETC Source Four
- 16 Template holders for Altman 360Q

Cable: Several hundred feet of GSP cable primarily in 10' and 25' (2m & 7.6m) cables, numerous two-fer pigtails, 4 each GSP/Edison PBG adapters M/F and F/M

VIDEO/FILM PROJECTION:

A Boxlight MP-41t digital video projector and a Christie 35mm film projector are both available at the theatre. The 35mm projector is permanently installed in the projection booth with all necessary gear to display 35mm films on the flown 20'(6m)high x 42'(12.8m)wide front projection screen.

The digital projector can be configured to work with various media formats and can be set up at the FOH Balcony Rail for front projection on the large screen, or backstage for Rear Projection on our 8'x10' RP screen. The Boxlight projector can project various PAL and NTSC formats, has up to 800 horizontal lines and 1024x768 pixel resolution with both interlaced and progressive capabilities and projects 3500 ANSI lumens. Throw ratio standard lens: 1.82-2.36. Short Zoom lens: 1.25-1.8.

VGA-over-Cat-5/6 system provides for video access points at Stage Right, FOH tech console, Projection Booth and Balcony Rail. Video control locations can be at any of these locations with the projector at either Balcony Rail or backstage.

Digital Video Hardware:

DVD Players

Digital Cable Television Box NTSC & HD capable

Component Video Switcher 4 inputs 2 outputs

Component/SVGA Video Converter

SVGA over Cat-5 cable extender

Portable DVD player for video monitor, composite input

Studio Video Monitor, composite input

Using the above equipment, our normal system takes multiple inputs including computer video and DVDs as well as (unscrambled) cable television signal through a switcher to select input device and into a SVGA over CAT-5 cable extender, allowing the playback system to be placed at FOH, in the projection booth, or backstage as needed, while the projector can remain at the FOH tech deck, backstage, or on the balcony rail as preferred.

Additionally, the Selecon Pacific Zoom lighting instruments have an air-cooled radiator, which keeps the gate cool, and can be used to project templates produced as easily as using an inkjet printer on overhead projector pages. Full-color personalized patterns can easily be inserted into these instruments and used for projecting onto any surface. Low contrast images only.

AUDIO SYSTEMS

Power: 120v single phase 20A Edison PBG circuits onstage and at FOH and installed amp racks. 2 Company Switches (3-phase 120/208, bare wire lugs) are available SL for touring sound/lights.

Wiring: 40 send 8 return from SR to FOH position. 8 send 1 return from Orchestra Pit SR to FOH. 6 sends from Projection Booth to FOH. Only 2 lines run to SL.

Control Locations: House Mix Position is at the center of the main floor, just in front of the balcony edge. 33'(10m) from stage front edge (38'(11.6m) from PL). 2-20A circuits at this position for Audio, plus 2-20A circuits for non-audio use. Tech deck has power and communications built into the 8'(2.4m) table, which is attached to the 6'(1.8m) lighting position table. Snakes run from this location to orchestra pit and SR through conduit routes; additional temporary snake routing requires approximately 150'(48m) of cable to avoid trip hazards to our patrons.

Assisted Listening System: A complete modern ALS system is available for all performances. Patrons can pick up ALS receivers and a variety of headset options in the Coat Room. Line feeds from FOH XLR input to processing and then to transmitter SR.

Page/Monitor System: Paging and program sound are available to all dressing rooms and backstage areas, except for the loading dock and rehearsal room. A microphone mounted to the balcony rail provides Program Sound; paging microphone is at SR: neither is routed through the FOH console.

Production Intercom: Positions at SR, SL, FOH Mix and Projection Booth. Clearcom-brand system; 7 headset & belt-pack combinations are available, as well as a single telephone-style handset at the system control box FOH next to the audio mixing position.

PA EQUIPMENT INVENTORY:

L/R Stereo Mains: 3-way EAW KF 650, KF695, (Flown) plus stereo Center Delay Fill. QSC Amplification. Rane digital signal processing system with remote FOH selection of pre-programmed presets.

- FOH:**
- (1) Midas Verona 480 FOH Console (48 Channel/8 Sub/8 Aux)
 - (1) Klark-Teknik DN360 Dual-Channel 1/3 Octave mains EQ
 - 9 Channels of Compression:*
 - (3) dbx 166XL dual compressor / limiters
 - (1) dbx 160A single channel compressor / limiter
 - (1) Symetrix 525 dual compressor/limiter
 - 8 Channels of Expander/Gate:*
 - (2) Aphex 105 quad gate
 - (1) Yamaha SPX 2000 Multi-Effect Processor
 - (1) TC Electronics D-Two Multi-tap Rhythm delay unit
 - (1) TC Electronics M-300 Reverb unit
 - 3 Channels of Parametric EQ:*
 - (1) Symetrix 551E 5-band parametric EQ
 - (1) Symetrix 552E Dual-channel 5-band parametric EQ
 - (1) Denon DN-600F Compact Disc Player
 - (1) Sony MDS E-10 Mindisc Player/Recorder
 - (1) Denon DN-770R Dual-deck stereo cassette tape recorder
 - (1) Marantz MPD910 DVD Player

- Monitors:** (1) Mackie Onyx 4080 monitor console, 40-channel 8-bus
(6) Mackie SRM-450 Self Powered 15" / 2"
(3) DBX 2231 Dual-channel 1/3 octave monitor EQ
(1) 32 channel signal splitter
(1) Sony DPS V55 Multi-Effects Processor

Microphones:

- (2) Shure ULX Wireless receivers with ULX handheld transmitters – 554-590 Mhz
- (1) Shure ULX Beta 58 Head
- (1) Shure ULX Beta 87 Head
- (2) Shure ULX-1 Beltpack Transmitters
- (1) Countryman E-6 Headworn microphone for ULX system
- (1) Countryman B-6 Lavalier microphone for ULX system
- (1) Vega / Beta 87 UHF wireless handheld
- (1) Vega / EV UHF wireless handheld
- (4) Vega UHF wireless lavalier
- (4) Vega UHF wireless receivers – Note that all our Vega systems are in the now reallocated 700mhz spectrum, so viable signal is not guaranteed. 3@ 746-766Mhz, 1@ 762-782Mhz.
- (2) Shure Beta 87 C Condenser Vocal Mics
- (1) Audix OM-3xb Vocal Mic
- (5) Shure SM-58
- (4) Shure SM-57
- (2) AKG C414B-XLS Large Diaphragm Condenser
- (2) Sennheiser MD421 Dynamic
- (2) Shure SM-81 Condenser
- (1) EV Bk1 Condenser Cardioid
- (3) Beyerdynamic TGX 105 Miniature Drum Mics
- (1) Audio Technica 4047-SV Large Diaphragm Condenser
- (1) Shure BG 4.1 Condenser
- (1) Shure SM94 Cardioid condenser
- (3) Countryman HHG II Miniature Hypercardioid condensers
- (5) Shure MX391 Boundary microphones

- (2) Radial JDI Duplex Direct Boxes
- (2) Radial J48 Active Direct Boxes
- (1) Radial JPC Active Personal Computer Direct Box
- (1) Countryman Type 85 Active Direct Box
- (4) Whirlwind Director Passive Direct Boxes

PROPS DEPARTMENT

Orchestra Pit:

When open, the orchestra pit extends from under stage to 6' (1.8m) beyond the apron edge at center. It normally accommodates 28-32 musicians. There is no elevator; the pit cover is created with custom Wenger platforms and typically requires 4 crew for about 2 hours to remove or reinstall.

40'-0" (12.2m) wide

14'-0" (4.3m) deep at center

11'-0" (3.4m) deep at SR/SL edge

-8'-5" (-2.57m) from stage elevation

The Pit Cover can also be raised up to stage level to provide a curving apron at the front of the stage, though this creates some sight-line issues with the front rows and balcony seating.

There is available a platform system to create a conductor's podium and 3 additional levels of orchestra seating, stepping down from the conductor's position at center to the orchestra floor at the back and sides. The platforms ring the conductor's position and each level is approximately 4'-5" (1.5m) deep. The outermost platform is at +1'-0" (30cm) above the Orchestra Pit floor; the next platform in is at +2'-0" (61cm), and the conductor's platform is adjustable according to the conductor's preference. *See attachment L for platform layout.*

Piano: Black Semi-Gloss Baldwin 7' (2m) Concert Grand. Normally tuned to A=440 pitch. Padded adjustable concert bench. Standard wooden non-adjustable bench is also available.

Stools:

(4) 24" (61cm) Blonde wood stools

(2) 24" (61cm) Black wood stools

(2) 32" (81cm) Swiveling metal stools with back rest

(3) 32" (81cm) Black metal stools

Chairs: 6 Wenger Black Musician Chairs

(70) Black & purple wooden dinner chairs with casters & armrests – used also for patrons in the secondary performance space which doubles as a rehearsal room.

(75) Green seashell-upholstered metal armless chairs – used also for additional seating for children's shows when the main floor has tables removed.

(4) Bentwood café-style chairs

(2) Wooden padded chairs

(2) Metal folding-style chairs, currently painted red.

Music Stands: 36 standard Manhasset Music Stands model 48

Stand Lights: 8 Standard 120v light fixtures with 20w tubular lamps.

Guitar Stands: 6 Guitar Stands

Keyboard Pedal: 1 Standard Expression Pedal

Drum Rugs: (1) 6'-6"x6'-5" (2m x 2m) & (1) 6'x9' (1.8m x 2.7m). Additional miscellaneous carpet pieces are available as well.

Conductor's Podium: A variety of platforms are available for use as a conductor's podium onstage. The conductor's podium in the orchestra pit is adjustable within 2" to nearly any height and is approximately 3' wide x 3' long.

Orchestra Shell: None currently available.

Platforms: All platforms in inventory are skinned with plywood and painted flat black.

(4) steel custom 4'x8' (1.2m x 2.4m) platforms with interchangeable legs; Legs bring platform height to: 8", 10", 16", 24" (20cm, 25cm, 41cm, 61cm)

(6) steel scaffold casters can be used as legs on steel platforms to create a rolling 14" (36cm) high platform.

(4) wood-construction custom 4'x8' (1.2m x 2.4m) platforms with interchangeable legs; Legs bring platform height to: 10", 16", 24" (25cm, 41cm, 61cm)

(2) wood-construction custom 4'x6' (1.2m x 1.8m) platforms, legs cut to fit as needed.

(1) 3'x6' (0.9m x 1.8m) wooden platform 8" (20cm) high

(1) 2'-6"x4'-0" (0.76m x 1.2m) platform 10" (25cm) high

Step Units: 4' (1.2m) wide stair step units:

(2) 1' (31cm) deep single-step 8" (20cm) high

(2) 2' (61cm) deep two-step 16" (41cm) high

(1) 3' (91cm) deep three-step 24" (61cm) high

Also (1) – 2-step stair unit 18" (46cm) wide by 19" (48cm) tall by 16" (41cm) deep

Stage Boxes: 2 custom black wooden stage boxes: 12"x18"x24" (31cm x 46cm x 61cm) usable as platforms, steps, amp stands, etc.

(1) 2' (61cm) wide by 8" (20cm) deep by 4.5" (11cm) high step/platform unit

Dance Floor: Harlequin Reversible 41' (12.5m) W x 26' (7.9m) deep in 4 6'-6" (2m) wide sections. Black/Grey.

Lecterns:

(1) standard lectern, a typical golden-oak color with magenta accents.

(1) art-deco lectern, larger and wider than standard, built to match the art-deco underwater motif in the house.

(1) artist-designed Plexiglas clear lectern with metal seaweed artwork framing the base.

Miscellaneous:

(1) United States Flag, post & base style

(1) Washington State Flag, post & base style

WARDROBE DEPARTMENT:

Dressing Rooms: *See Attachment H for dressing room plots.*

Six dressing rooms are available on two levels. Stage level dressing rooms include Dressing Rooms #1 and #2 with private bathroom (DR1 with a shower), which can accommodate 1-4 people, and Dressing Room #3, which can accommodate 6-8 with a bathroom across the hall.

One floor up from stage level is Dressing Rm. #4 (ensemble) for 16 or more and #5 and #6 can accommodate 4-5 each. Private restrooms are available at this level, across the hall. Dressing Rm #4 has a sink as well.

One floor down from the stage is the Green Room, which accommodates approximately 20. The green room also has an attached restroom. No shower facilities are available except in dressing room #1.

Wardrobe Area: The Wardrobe Area is backstage right near Dressing Rooms 2 & 3 and the Production Staff Office. It is a 16'x12' (4.9m x 3.7m) room with a 6'-6" (2m) curtained entryway, with dressing-room counters along one 16' (4.9m) wall. If not needed for wardrobe it can be used as an additional dressing room. A short 10" (25cm) ramp from this area accesses stage level.

Irons: 2

Ironing Boards: 2

Steamers: 1 portable steamer

Sewing Machine: 1 Industrial Sewing Machine available upon request.

Washer & Dryer: 1 set of modern household style, in a wide closet in the wardrobe room. Please provide your own laundry detergent.

Racks & Hangers: Three full-size rolling wardrobe racks are available; Dressing rooms 4, 5, and 6 all have small built-in wardrobe racks; other small wardrobe racks are also available upon request.

Quick-Change Booths: Two permanent quick-change booths with curtained entrances are available backstage at SR, accessible from the crossover hallway or the DSR wing.

Notes: Additional spaces can be used for dressing rooms when necessary; please contact PSM Gail Walls if you have any questions or concerns regarding wardrobe and dressing room space.

ATTACHMENTS:

- A Bremerton Area Map
1 page, letter-size
- B Theatre Plot, 1/4" Scale (1:48)
1 page, 18"x24"
- C Theatre Centerline Section, 1/4" Scale (1:48)
1 page, 18"x24"
- D Line-set Schedule and Line-set plot 1/8" Scale (1:96)
1 page, letter-size
- E Seating Charts, Typical Main Floor layout and Permanent Balcony Layout
2 pages, letter-size
- F Circuit Schedule
1 page, letter-size
- G Circuit Plot, Stage & House 1/8" Scale (1:96)
2 pages, letter-size
- H Dressing Room Plots, 1"=10'-0" Scale (1:120)
3 pages, letter-size
- J House Lighting Plot, 1/8" Scale (1:96)
2 pages, letter-size
- K House Patch Schedule
4 pages, letter-size
- L Orchestra Pit Platform Plot, 1/8" Scale (1:96)
1 page, legal-size
- M Photographs
 - House
 - Mainstage
 - Orchestra Pit
 - Loading Dock & Alley